

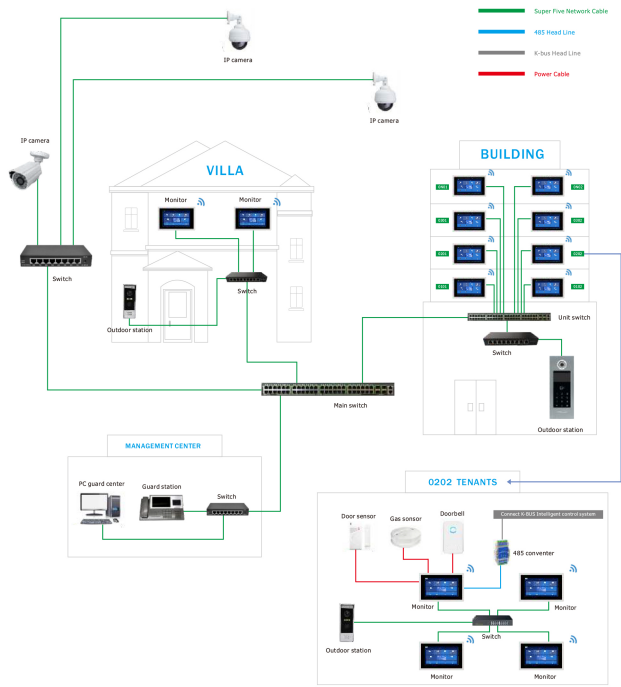

System Diagram



PIXELS CONNECT PTE LTD OPERATION INSTRUCTION TCP/IP Video Doorphone

Outdoor Unit
User Manual



CCTV
Analog Camera, IP Camera
Dome & Bullet Cameras
Hidden Cameras
PTZ Cameras

Wireless Cameras
Panoramic Camera
4-in-1 Action Camera | Car Cameras
Battery Cameras
WiFi Door Bells
Hidden Cameras

Biometric Devices
Fingerprint | Face | Card |
Access IPN Reader
Electromagnetic Lock
Exit Button | Break Glass
Video Door Intercom



PIXELS CONNECT PTE LTD
1013, Geylang East Ave 3, #01-144 Singapore 389728
pixelsconnect@gmail.com | www.pixelsconnect.com.sg | Tel:+65 6440 0023

Appearance introduction

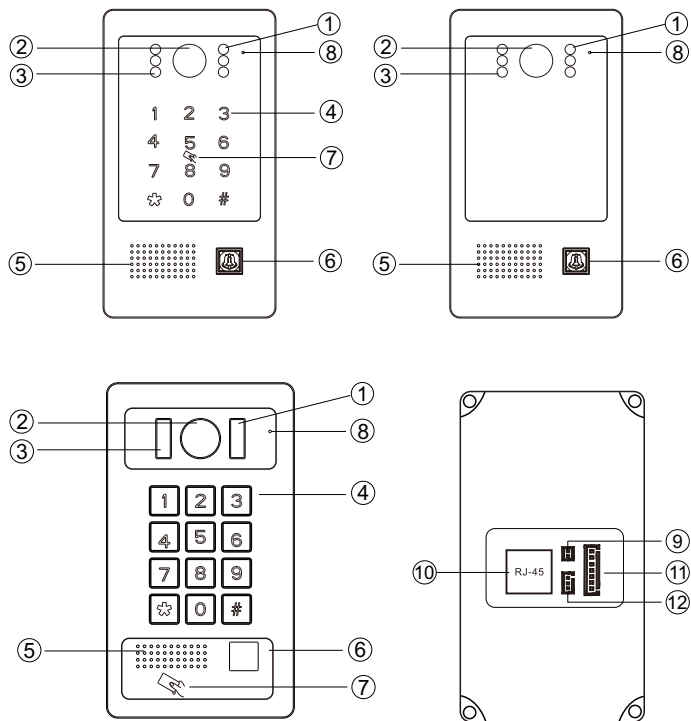

1	White light LED	5	Speaker	9	DC input
2	Camera	6	Call button	10	POE interface(RJ45)
3	Photo resistor	7	RFID card area	11	Lock control integrated interface
4	Digit button	8	Microphone	12	RS 485 interface

I Parameters

1. Camera sensor:
Camera sensor automatically switches between day and night modes.
2. View angle: 110°
3. Resolution:1.0MP
4. LED night vision: white light LED (120°)
5. Working voltage and current
Input DC: +12V →+15V; POE power supply
Working current: Standby: ≤150mA, working: ≤300mA,
6. Working environment:
Ambient temperature:-20°C ~ 50°C; Relative humidity:≤95%
7. Lock control integrated interface

NO .	Location	Definition	Function	Remark
J1	1	NO_DC20V (Brown)	Power supply for Electric lock	
	2	NC (Orange)	Normally close	
	3	COM (Green)	Common terminal	
	4	NO (Yellow)	Normally open	
	5	CTL (Black)	Exit button	
	6	DET (White)	Door sensor	
	7	GND (Red)	Ground	

8. RS 485 interface: used for lift control etc

NO .	Location	Definition	Function	Remark
J3	1	RS 485B	485B date	
	2	RS 485A	485A date	
	3	GND	Ground	

II Function introduction

This product features include access control card RFID + access Controller + video audio intercom, it can be used for factory, home, office, bank and community etc, provide security service.

1. This product has digit password unlock function and RFID unlock function. In this manual, the digital keypad will be used for administrator mode operation. The RFID part will be used for manage user card operations.

2. White light LED and digit button back light LED with light sensing function. At day time, when calling or standby, both the white light LED and backlight LED will not light up. At night, backlight LED always on. When calling, white light LED will automatically turn on to fill the light.

III Administrator operation

1. Default setting as below:

Initial administrator password is 999999. Initial public unlock password is 123456.

The default door opening method is RFID;

The default unlock time is 2 seconds;

Safe mode is turned off by default;

The public unlock password is enabled by default.

2. Enter administrator operation mode

*** + Adm Pwd + #**

Under standby mode, press * + administrator password (Initial administrator password is 999999) + # to enter administrator operation mode, buzzer with Bi Bi—the device makes two sounds and call button flash slowly, means entered administrator operation mode successfully.

In setting process, if input is incorrect or the setting fails, the buzzer will with 4 times Bi Bi Bi Bi. After setting done, if no more operations, the buzzer will with 3 times Bi Bi Bi after 30 seconds, means automatically exit administrator operation mode.

NOTICE:

Press * button during any of the following settings can return to the previous level or exit the operating mode.

2.1 Modify administrator password, public unlock password and reset the device.

2.1.1 Public unlock password

0 + 11+ # +New Pwd + # +Confirm Pwd+ #

Under administrator operation mode, press 0 (Call button light flash fast) +11 + # NNNNNN (six digits)+#+NNNNNN (input password again) + #, the device buzzer with two sounds Bi Bi means set successfully.

How to use the public unlock password:

Input public unlock password on the keypad + #, if password correct then door will be unlocked.

2.1.2 Administrator password

0 + 77+ # +New Adm Pwd + # +Confirm Adm Pwd+ #

Under administrator operation mode, press 0 (Call button light flash fast)+77 + # NNNNNN (six digits)+#+NNNNNN (input password again)+#, the device buzzer with two sounds Bi Bi means set successfully.

2.1.3 Reset

There are two ways to restore factory setting.

1). 0 + 99+

Under administrator operation mode, press 0 (Call button light flash fast)+99 + # (buzzer with one sound Bi), device restored to factory setting.

2). Under standby mode, keep press call button 10s can reset the device.

NOTICE:

Reset the device will not delete user card, user password info and master card.

2.2 Setup unlock mode

1). 3 + 00+

Under administrator operation mode, press 3 (Call button light flash fast)+00+ # (buzzer with two times Bi Bi) -----The card unlock only.

2). 3 + 01+

Under administrator operation mode, press 3 (Call button light flash fast)+01+ # (buzzer with two times Bi Bi)----- The card or password unlock.



3). 3 + 02+

Under administrator operation mode, press 3(Call button light flash fast) + 02 +# (buzzer with two times Bi Bi)----- The card and password unlock.

2.3 Modify the unlock time of relay

Under administrator operation mode, press 4 (Call button light flash fast) +000~150(unlock time)+# (buzzer with two times Bi Bi means set successfully)

1). 4 + 002+

Under administrator operation mode, press 4 (Call button light flash fast) +002+# (buzzer with two times Bi Bi means set successfully). Unlock time set to 2s, and so on.

2). 4 + 000+

Under administrator operation mode, press 4 (Call button light flash fast) +000+#(buzzer with two times Bi Bi means set successfully). This setting means first s wipe card is on; swipe the card again is off.

2.4 Safety mode setup

1). 5 + 00+

Under administrator operation mode, press 5 (Call button light flash fast) +00+# (buzzer with two times Bi Bi)-----Turn off safety mode.

2). 5 + 01+

Under administrator operation mode, press 5 (Call button light flash fast)+01+# (buzzer with two times Bi Bi)----- Locked mode. (Means within 5 minutes, continue use wrong card or incorrect password for 10 times, the device will be locked out for 2 minutes, button light fast flashing, indoor monitor start monitoring automatically. Then card and password won't work in this 2 minutes.

3). 5 + 02+

Under administrator operation mode, press 5 (Call button light flash fast)+02+# (buzzer with two times Bi Bi)----- Alarm mode (Means within 5 minutes, continue to use wrong card or incorrect password for 10 times, the built in buzzer will alarm for 1 minute, button light fast flashing, indoor monitor start monitoring automatically).

2.5 Enable and disable public unlock password

1). 6 + 00+

Under administrator operation mode, press 6 (Call button light flash fast)+00+ # (buzzer with two times Bi Bi)----- Disable public unlock password.



2). 6 + 01+

Under administrator operation mode, press 6 (Call button light flash fast) +01+ # (buzzer with two times Bi Bi) ----- Enable public unlock password.

2.6 Add master card

7 +

Under administrator operation mode, press 7 (Call button light flash fast)+# (buzzer with two times Bi Bi) to enter add master card mode, the first card registered in this mode will become Add Card Master Card, second card registered in this mode will become Delete Card Master Card. After swipe two cards, administrator operation mode will be exited automatically.

NOTICE:

Only two pcs master card allowed, both master cards are capable to unlock. New added master card will replace the original master card.

IV Manage user card

There are two master cards, one is Add Card Master Card, another one is Delete Card Master Card (For modification of master card please refers to administrator operation point 6). User card can only managed by master card.

NOTICE:

- 1. Master card can't be deleted, it can only be replaced by new adding master card.**
- 2. The master card and user card registered in door station 1 can't unlock other door station. If user wants the card to unlock every door, user should register the card at every door station.**

1. Add user card

- 1). In standby mode, swipe add card master card 3 times within 15 seconds, call button light flash fast means entered add user card mode successfully.
- 2). Swipe the unregistered blank card in RFID read area, when buzzer with "Bi Bi" sound means this card is added successfully.
- 3). If all user cards have been added, or user want to stop adding, just swipe add card master to end the add user card operation. (If no more operations, it will exit add user card mode automatically after 30s), at this time the call button back light always on and the device returns to the standby state.

2. Delete user card

Delete part of user card

- 1). In standby mode, swipe delete card master card 3 times within 15 seconds, call button light flash fast means entered delete user card mode successfully.
- 2). Swipe a registered user card on RFID read area, when buzzer with "Bi Bi" sound means this card is deleted successfully.
- 3). If all user cards have been deleted, or user want to stop delete card, just swipe delete card or keep press the call button to exit delete user card mode. (If no more operations, it will exit delete user card mode automatically after 30s), at this time the call button back light always on and the device returns to the standby state.

Delete all user cards

- 1). In standby mode, swipe delete card master card 3 times within 15 seconds, call button light flash fast means entered delete user card mode successfully.
- 2). Under delete user card mode, swipe add card user card, buzzer with 7 times BI BI..... then delete all user cards and back to standby mode.

V User operations

User modify password by card:

***+ User Card+old PWD+ # +New PWD + # +Confirm PWD+ #**

In standby mode, press *+swipe card +old password (default user password 0000) +#+NNNN (4 digits as new password) +#+NNNN (Input password again) +#, if no mistake on operation, then the buzzer will ring as Bi, means password modified successfully.

NOTICE:

Default user password can only use for first time modify user password, it can't be used for unlock.

Card access to unlock

In standby mode, swipe valid registered card at the RFID read area, can unlock the door and hear the indicate voice "The door is open, please come in".

ID Card or password unlock

- 1). In standby mode, swipe valid registered card at the RFID read area, can unlock the door and hear the indicate voice "The door is open, please come in".
- 2). In standby mode, input 4 digit user password at keypad +#, if password is right then unlock successfully and hear the indicate voice "The door is open, please come in".

IC Card and password unlock

- 3). In standby mode, swipe valid registered card at the RFID read area, input 4 digit user password at keypad +#, if both card and password are valid can unlock the door and hear the indicate voice "The door is open, please come in".

VI Wiring Diagram

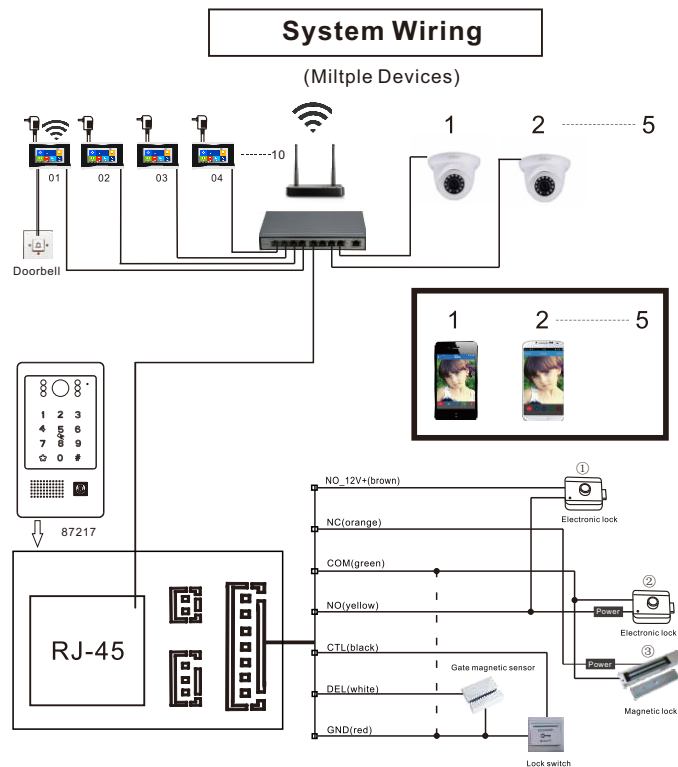

System Wiring

(one to one)

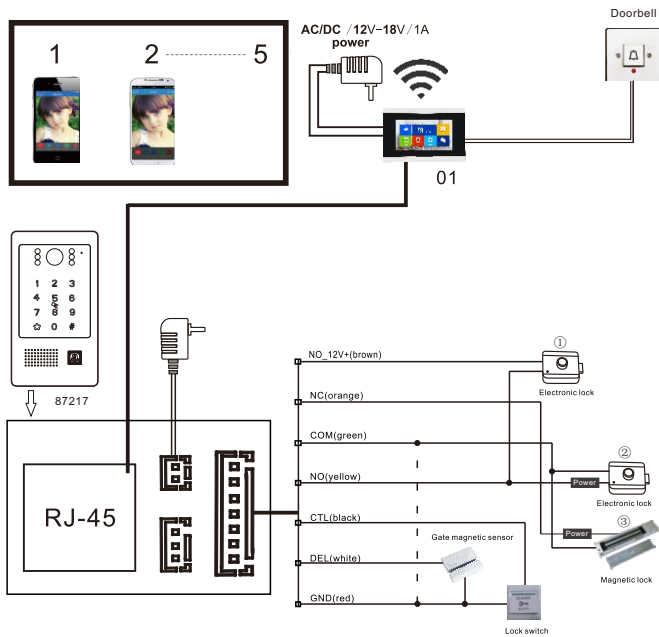

Surface Mount

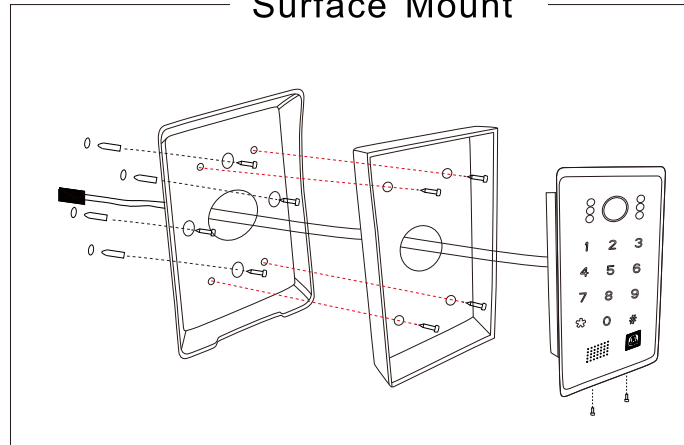

Flush Mount

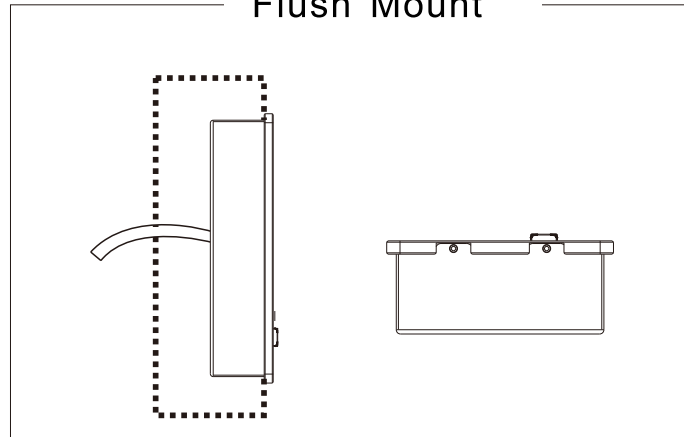

VII Accessories

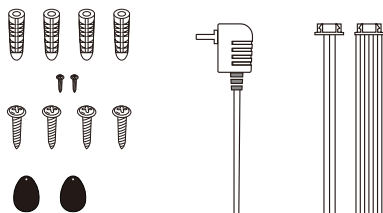
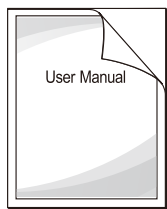
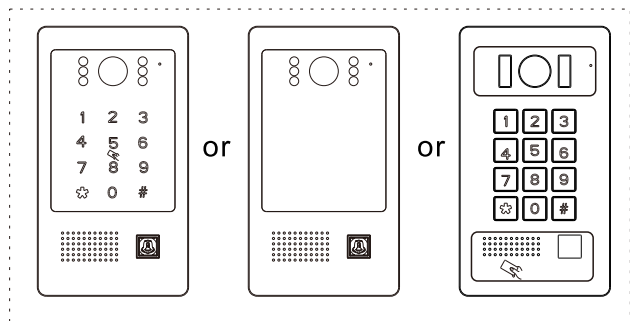

- Access unit ----- 1PCS
- Plastic Anchors ----- 4PCS
- Screws ----- 6PCS
- User manual ----- 1PCS
- Power adapter----- 1PCS
- 3 Pin line ----- 1PCS
- 7 Pin line ----- 1PCS
- IC card ----- 2 PCS

VIII Installation process of outdoor units

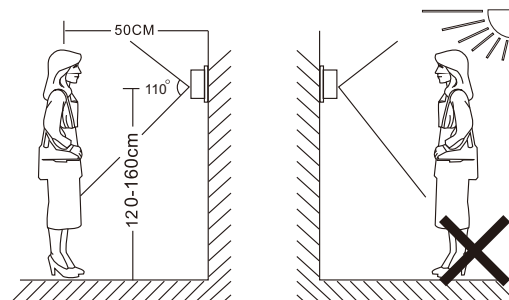

NOTE:

- Avoid installation of the device near strong radiation e.g. AC motor and lift .
- Maintenance should be complied with qualified technician .
- Avoid hard shake , beating and collision ,otherwise the internal exact components maybe be damaged .
- Do not expose the outdoor camera under strong light or sunshine.
- Do not install the outdoor camera in the environment e.g. direct sunlight ,contact rain ,High temperature ,high humidity ,full of dust and chemistry corrosive.
- Select the most suitable position where the camera is located at user's eye level
- Switch off power supply before installation.
- Keep more than 30cm away from AC power supply to avoid external interference.
- Keep it away from the water and magnetic field.